

# Zylinder-Hebelschloss/Zylinder-Druckschloss Prestige 2000 für auswechselbare Innenzylinder

## Zylinder-Hebelschloss

- Mit montiertem Riegel, 2 mm gekröpft
- rechts und LAD schließend (je nach Einbausituation)
- Komplett mit Rosette
- Vernickelt

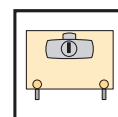
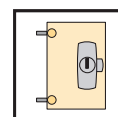
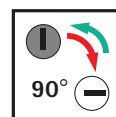
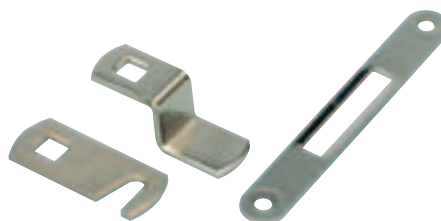

### Set besteht aus:

- 1 Prestige 2000 Zylinder-Hebelschloss mit montiertem Riegel, 2 mm gekröpft
- 1 Rosette
- 1 Schließblech
- 1 Riegel 11 mm gekröpft
- 1 Riegel flach

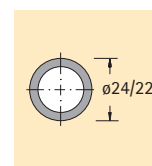
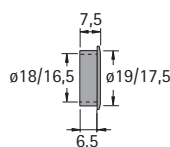
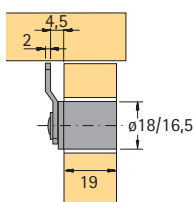
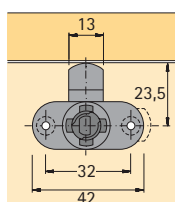

### Schließblech

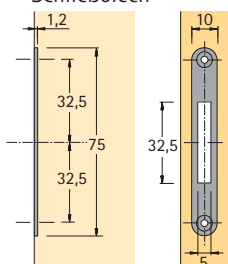

### Riegel gekröpft

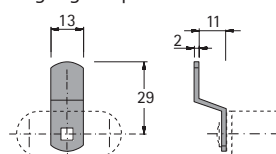

### Riegel flach

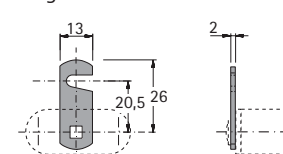

Bestell-Nr.	VE
Z23, ø 18 mm	Z25, ø 16,5 mm
0 072 502	9 078 913
0 078 020	9 078 924
	1 Set

## Prestige 2000 Zylinder-Druckschloss

- Komplett mit Rosette
- Vernickelt

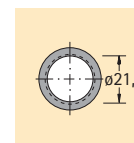
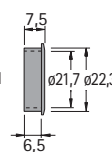
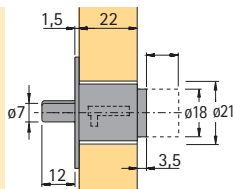
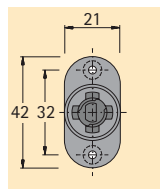
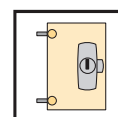
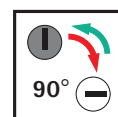

Bestell-Nr.	VE
Z23, ø 18 mm	Z25, ø 16,5 mm
0 072 501	9 078 910

## Hartmetall-Bohrer für Prestige 2000-Schlösser, Rosetten und Zylinder-Druckschloss

- Nur für Ständer- und Handbohrmaschinen



Hartmetall-Bohrer für	Bohr ø mm	Bestell-Nr.	VE
Prestige 2000-Schlösser	18	0 046 087	1
Rosetten	19	0 046 078	1
Zylinder-Druckschloss	22,3	0 046 076	1